



Product **2 1/2" Corrugated**



FL No.	6895.1
---------------	---------------

Material	Finish
	Galvalume Painted

Gauge (minimum)	26
------------------------	-----------

Deck Description	Plywood
	New construction: 19/32" Existing construction: 15/32"

Deck Attachment	Spacing
	Nails: 8d - 2" ring shank nails: 6" O.C. Screws: #8 - 2" wood screws: 6" O.C.

Underlayment	30# Felt
---------------------	-----------------

Roof Slope Ranges	Sealant
	Slope: 1/2 /12 to less than 3/12: Side Lap
	Slope: 3/12 and greater: None

Panel Fasteners	Spacing
	SDS Screws: #9-15 x 1 1/2" long: See Tables

Fastener Spacing (along panel length, inches)					
Wind Z Speed mph	one No. Roof Hip Location	Roof Slope			
		Gable Roof			Roof
		.5 to <1.5/12	1.5 to <6/12	6 to 12/12	1.5 to 5.5/12
100	1 Field	24	24	24	24
	2 Edge	24	24	24	24
	3 Corner	24	24	24	24
110	1 Field	24	24	24	24
	2 Edge	24	24	24	24
	3 Corner	24	24	24	24
120	1 Field	24	24	24	24
	2 Edge	24	24	24	24
	3 Corner	24	24	24	24
130	1 Field	24	24	24	24
	2 Edge	24	24	24	24
	3 Corner	24	24	24	24
140	1 Field	24	24	24	24
	2 Edge	24	24	24	24
	3 Corner	24	24	24	24

Fastener Spacing* (across panel width)	Location
	Panel Ends (eave, valley, hip and ridge): 5 1/4" o.c. Ribs and Flat
Place fasteners 2" from panel end	
Between Panel Ends (Intermediates): 10 5/8" o.c.	Ribs Only

*Fastener spacing based on testing

Notes:

1. Read all Notes before purchasing material and check compliance of the product with local building code requirements.
2. The Fastener Spacing Table below is based on a mean roof height of up to 25' for Exposure C. For roof eave heights over 25' and other exposures contact Union Corrugating Company.
3. Installation must be in complete compliance with the materials and related specifications listed on this page, 1/2" Corrugated Installation drawings, and the Florida Building Code RAS No. 133.
4. See 2 1/2" Corrugated installation drawings for additional approved trim details and applications.
5. Refer to Florida Building Code RAS No. 133 "Standard Procedures for Installation of Metal Roof Systems".
6. For applications not in compliance with this product approval as listed contact Union Corrugating Company for other options.
7. This application and installation method is not for use in HVHZ areas governed by Miami Dade Product Approval. See the Union Corrugating Miami Dade Approved Product use guide for these areas.
8. If the roof has both Gables and Hips use the Gable Roof Fastener Spacing Table.
9. For Hip Roof slopes greater than 5.5/12 use Gable Roof Table, 6 to 12/12 column.
10. Guide is subject to change without notice.

Calculate Zone width (dimension "a"):

$a = LHD \times 10\%$

Note: "a" must be a minimum of 3'.

Gable Roof Zones (dashed areas)

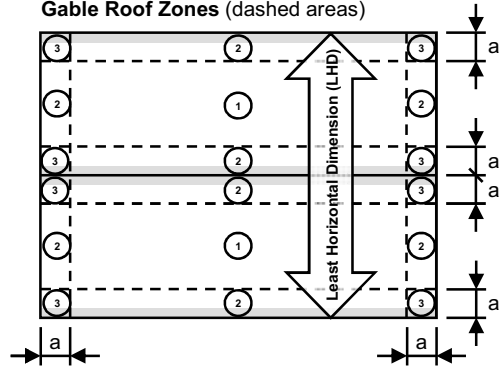

Hip Roof Zones (dashed areas)

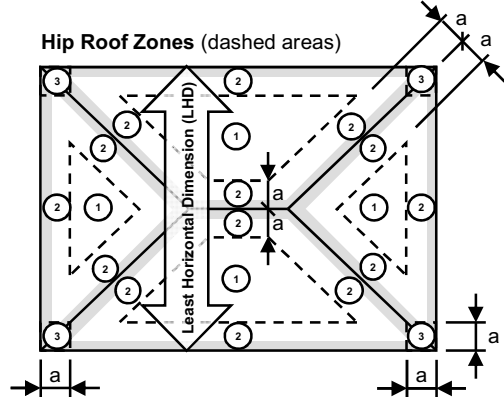

Gray highlighted lines indicate the location of panel end fastening at the eave, hip, valley (not shown), and ridge.

**EVALUATION REPORT OF
UNION CORRUGATING COMPANY
'26 GA. 2-1/2" CORRUGATED PANEL'**

**FLORIDA PRODUCT APPROVAL
#FL 6895.1-R1
ROOFING
METAL ROOFING**

**Prepared For:
Union Corrugating Company
P. O. Box 229
Fayetteville, NC 28302
Telephone: (910) 483-0479
Fax: (910) 483-8897**

**Prepared By:
Bala Sockalingam, Ph.D., P.E.
Florida Professional Engineer #62240
6717 South Yale Avenue, Suite 200
Tulsa, OK 74136
Telephone: (918) 492-5992
FAX: (918) 493-3568**

**This report consists of
Evaluation Report (2 Pages including cover)
Installation Details (1 Page)**

**Report No. C1605-1
Date: 8.17.08**



Manufacturer: Union Corrugating Company

Product Name: 2-1/2" Corrugated Panel

Panel Description: 21-1/4" wide coverage with (10) 1/2" high

Materials: Min 26 ga. with galvanized coated steel (ASTM A653) or Galvalume coated steel (ASTM A792) or painted steel (ASTM A755) in Grade E ($F_y = 80$ ksi).

Deck Description: 19/32" CDX Plywood (New Construction)
15/32" CDX Plywood (Existing Construction)

Deck Attachment: 8d x 2-1/2" long ring shank nails or #8 x 2" long wood screws @ 6" o.c. in the plywood field and edges

Slope: 1/2:12 or greater in accordance with FBC 2007 Section 1507.4.2

Design Uplift Pressure: 129.25 psf @ fastener spacing of 24" o.c.
(Factor of Safety = 2)

Panel Attachment:
At panel ends #9-15 x 1-1/2" long SDS @ 5.25" o.c. across panel width
At intermediate #9-15 x 1-1/2" long SDS @ 10.625" o.c. across panel width

Test Standards: Roof assembly tested in accordance with UL-580-94 'Uplift Resistance of Roof Assemblies' & UL 1897-98 'Uplift Tests for Roof Covering Systems'.

Code Compliance: The product described herein has demonstrated compliance with FBC 2007 Section 1507.4.

Product Limitations: Design wind loads shall be determined for each project in accordance with FBC 2007 Section 1609. The maximum fastener spacing listed herein shall not be exceeded. This product is not approved for use in the High Velocity Hurricane Zone.

Supporting Documents: UL 580 Test Report
Hurricane Test Laboratory
Report No. 0293-0203-06, Reporting Date 4/5/06

PANEL FASTENER
#9-15 SDS
1-1 1/2" LONG

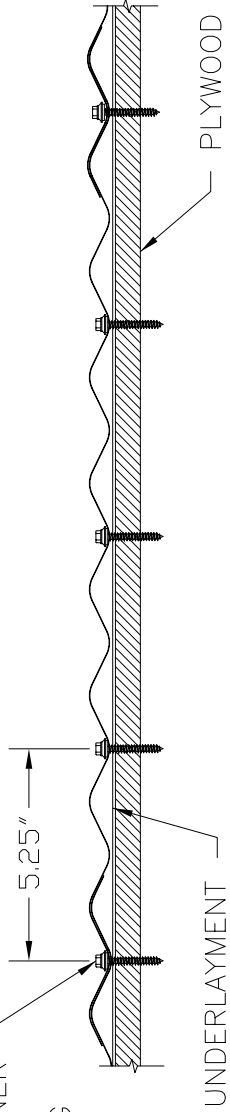

PLYWOOD DECKING
(MIN 19/32" THICK)

FASTENER PATTERN @ EAVE, RIDGE & VALLEY

PANEL FASTENER
#9-15 SDS
1-1 1/2" LONG

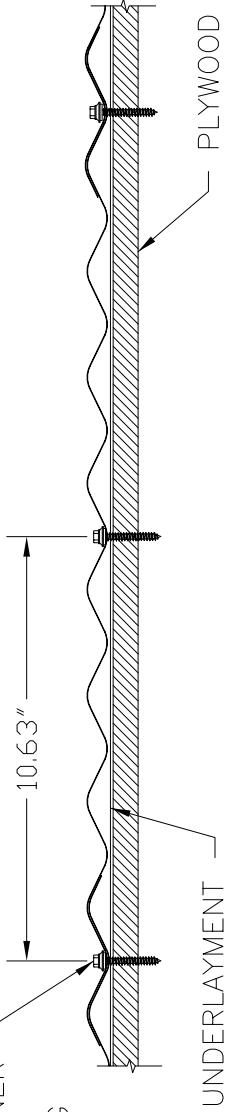

PLYWOOD DECKING
(MIN 19/32" THICK)

FASTENER PATTERN @ INTERMEDIATE LOCATIONS

ALLOWABLE UPLIFT PRESSURE

FASTENER SPACING (IN)	PRESSURE (PSF)
24	129.25

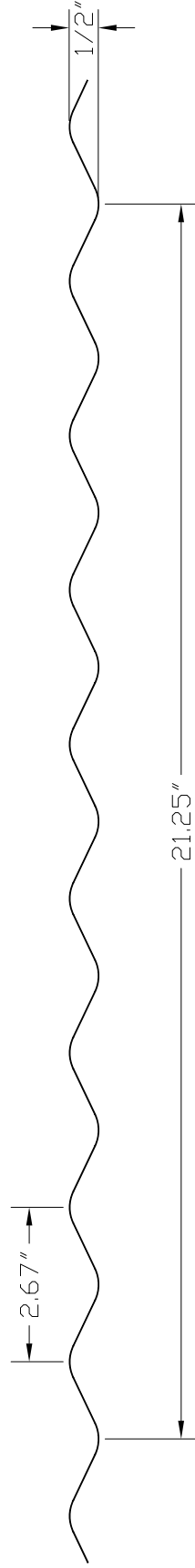

Corrugated Panel Profile

26 Gauge, Minimum Yield = 80 KSI

